

SUPERPOINT 4 LED



VERSIONE STANDARD



VERSIONE CON STAFFA



VERSIONE DRITTA



VERSIONE CORTA



CARATTERISTICHE PRODOTTO

- Lente in policarbonato resistente
- Supporto in gomma flessibile e infrangibile
- Inclusa luce laterale arancione
- Dimensioni compatibili con SUPERPOINT 2 3
- Bivoltaggio 12V/24V

PRODUCT BENEFITS

- End outline marker in clear glass design complete in LED
- Different flexible fitting arms (rubber)
- Lamp includes side marker lamp
- Dimensionally compatible to Superpoint II and Superpoint III
- dual voltage

SUPERPOINT 4 LED



DATI TECNICI		
VOLTAGGIO: VOLTAGE RANGE:	12 - 24 V	
CONSUMO: POWER:	Posizione anteriore: <i>Position light front:</i>	0,5 Watt
	Posizione posteriore: <i>Position light back:</i>	0,5 Watt
	Luce laterale: <i>Side marker light:</i>	0,5 Watt
CONNESSIONE: CONNECTION:	cavo 1 m (2x0,75 m ² DC) cavo 2 m (P&R)	2 m ASS2
MATERIALE: MATERIAL:	Lente: <i>Lens</i>	PMMA
	Gomma <i>Rubber</i>	SEBS nera
	Riflettore <i>Reflector</i>	ABS
RANGE TEMPERATURE: TEMPERATURE RANGE:	-30°C ~ +50°C	
IP-GRADO PROTEZIONE: IP-RATING:	IP69K	
EMC-APPROVAZIONE: EMC APPROVAL:	R10	
ECE-APPROVAZIONE: ECE- APPROVAL:	E9-6878-00	E9-6878-02

VERSIONE STANDARD

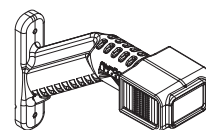
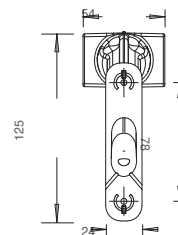
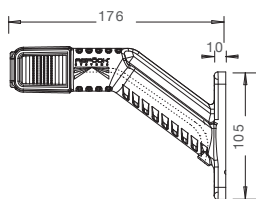

VERSIONE CON STAFFA

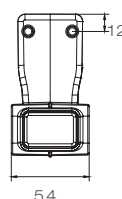
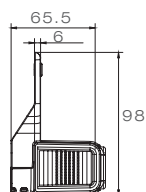

SUPERPOINT 4 LED

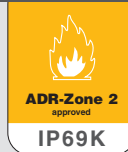

VERSIONE DRITTA

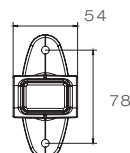
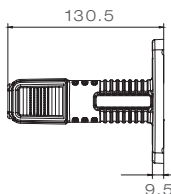

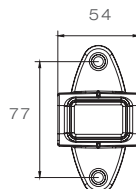
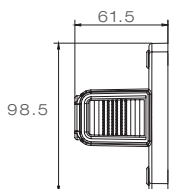

VERSIONE CORTA



DESCRIZIONE		CODICI
 <p>Version Standard, Seitenmarkierungsleuchte orange Version standard, side marker lamp orange rosso/bianco/arancione sinistro, con connessione ASS2, cavo 2m red/white/orange left, with ASS2 connection, with 2m cable rosso/bianco/arancione destro, con connessione ASS2, cavo 2m red/white/orange right, with ASS2 connection, with 2m cable rosso/bianco/arancione sinistro, con connessione P&R, cavo 2m red/white/orange left, with P&R connection, with 2m cable rosso/bianco/arancione destro, con connessione P&R, cavo 2m red/white/orange right, with P&R connection, with 2 m cable rosso/bianco/arancione sinistro, con cavo 1m DC red/white/orange left, with 1m DC cable rosso/bianco/arancione destro, con cavo 1m DC red/white/orange right, with 1 m DC cable</p>		<p>31-3105-007</p> <p>31-3106-007</p> <p>31-3104-007</p> <p>31-3104-017</p> <p>31-3109-017</p> <p>31-3109-007</p>

SUPERPOINT 4 LED



DESCRIZIONE		CODICI
 <p>Versione corta Version direct mounting</p> <p>rosso/bianco/arancione sinistro, cavo 1m DC red/white/orange left, with 1 m DC cable rosso/bianco/arancione destro, cavo 1m DC red/white/orange right, with 1 m DC cable</p>		<p>31-3109-077</p> <p>31-3109-067</p>
 <p>Versione con staffa Version pendular bracket</p> <p>rosso/bianco/arancione sinistro, cavo 1m DC red/white/orange left, with 1 m DC cable rosso/bianco/arancione destro, cavo 1m DC red/white/orange right, with 1 m DC cable</p>		<p>31-3109-097</p> <p>31-3109-087</p>
 <p>Version dritta Version short</p> <p>rosso/bianco/arancione sinistro, cavo 1m DC red/white/orange left, with 1 m DC cable rosso/bianco/arancione destro, cavo 1m DC red/white/orange right, with 1 m DC cable</p>		<p>31-3109-117</p> <p>31-3109-107</p>